

# UAL-7

fronty z uchwytami  
fronts with handles

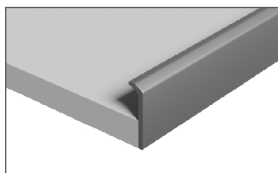

Szuflada  
Drawer front



Front pełny  
Full front



Witryna  
Glass door

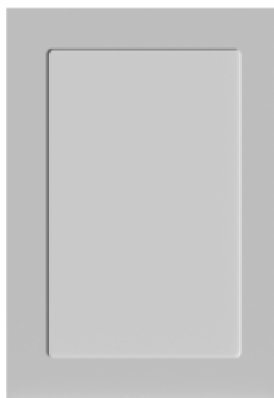

Witryna z kratką  
Frame with lattice

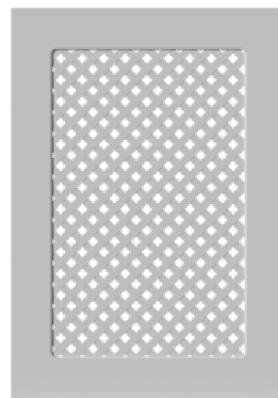

Wymiar min elementu / Minimum size available	szer. / width [mm]	wys. / height [mm]
bez frezu wew./ without internal edge	220	50
z frezowaniem / with internal edge	-	-
Wymiar max elementu / Maximum size available	1200	2500 (2700*)

Szerokość ramy  
Frame thickness:  
60/60 mm

\* front surowy / raw front

UAL-7/1

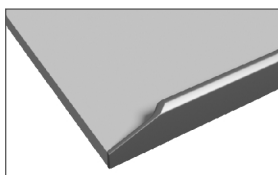

Front pełny  
Full front

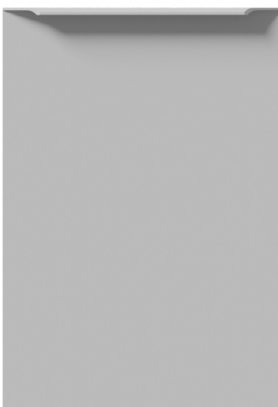

Rozmieszczenie uchwytów / Position of handles  
drzwi, witryny / door, glass door

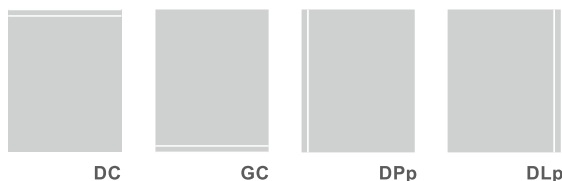

DC - drzwi dolne centralnie; GC - drzwi górne centralnie; DPP - drzwi dolne prawe pionowo;  
DLp - drzwi dolne lewe pionowo

DC - base door top edge; GC - wall door bottom edge; DPP - base door left hand side vertical;  
DLp - base door right hand side vertical

Przekrój drzwi poziomo  
Horizontal door section



Przekrój drzwi pionowo  
Vertical door section



# UAL-7

fronty z uchwytemi  
*fronts with handles*

